

logistics details

Product title:	Insulated spade terminals KWI type
Type:	KWI 10/6 (100 SZT./PCS)

Certificates

Design	DIN 46237 – refers only the tubular part of terminal
--------	---

mechanical details

Insulated	polyamide 6.6
Insulation color	red
Material	Cu
Surface	tin-plated
Working temperature [°C]	-30 ÷ +95
Size of bolt dia	M 6
Release	B

Sections

Cross section [mm ²]	10
----------------------------------	-----------

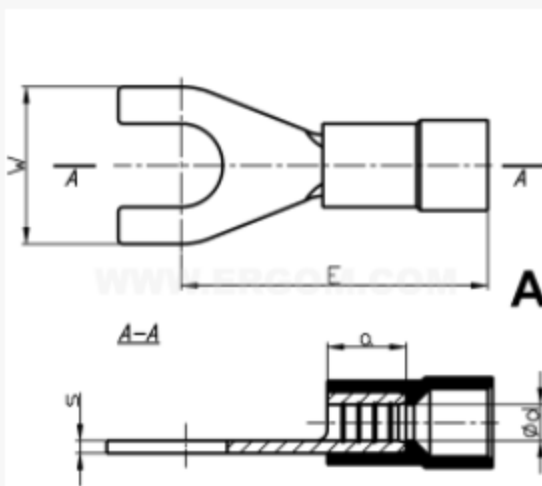

Sizes

d	4,5
s	1,1
a	8
E	25
W	11